

## User Manual

# SOFTBOX

UltranelPRO 30 - SuperpanelPRO 30  
UltranelPRO 60 - SuperpanelPRO 60  
DayledPRO 650 / 1000 / 2000 / 3000

## SuperpanelPRO 30 and UltranelPRO 30 instructions

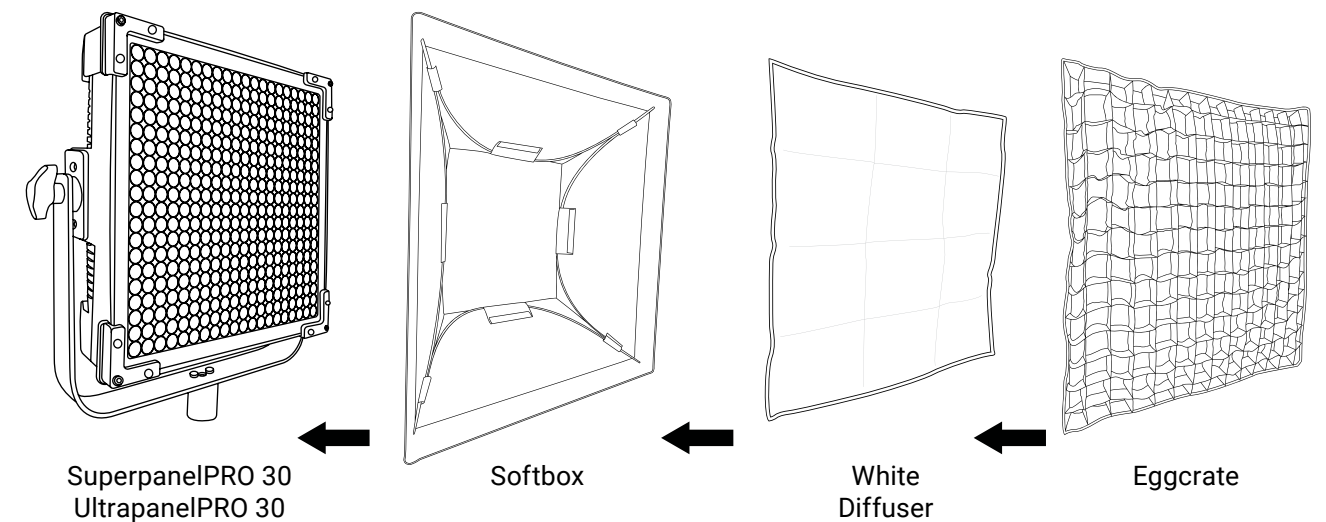

To use the softbox, open the velcro string at the edges of the panel and make sure to tighten it. (fig 1)

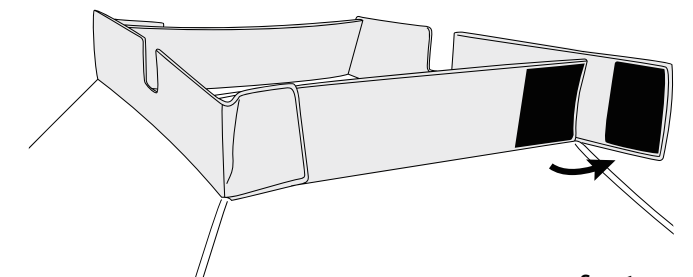

fig. 1

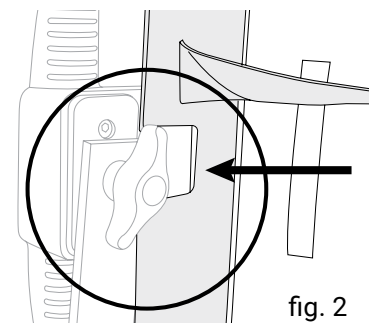

fig. 2

**⚠ Attention:** please note this is the right way to mount the softbox on the SuperpanelPRO 30 or the UltranelPRO 30. (fig 2)

Please use the strap on the back to secure the softbox to the panel. (fig. 3)

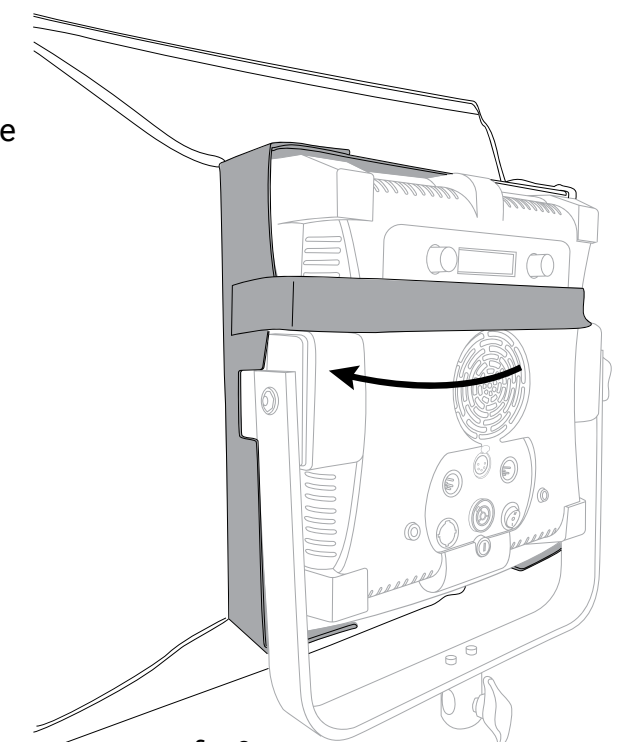
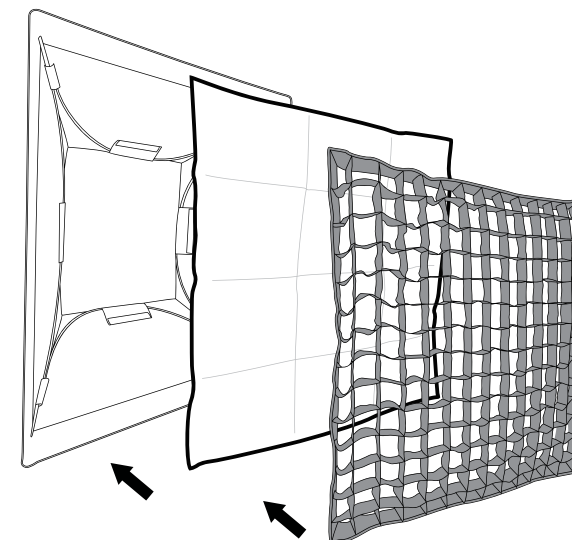
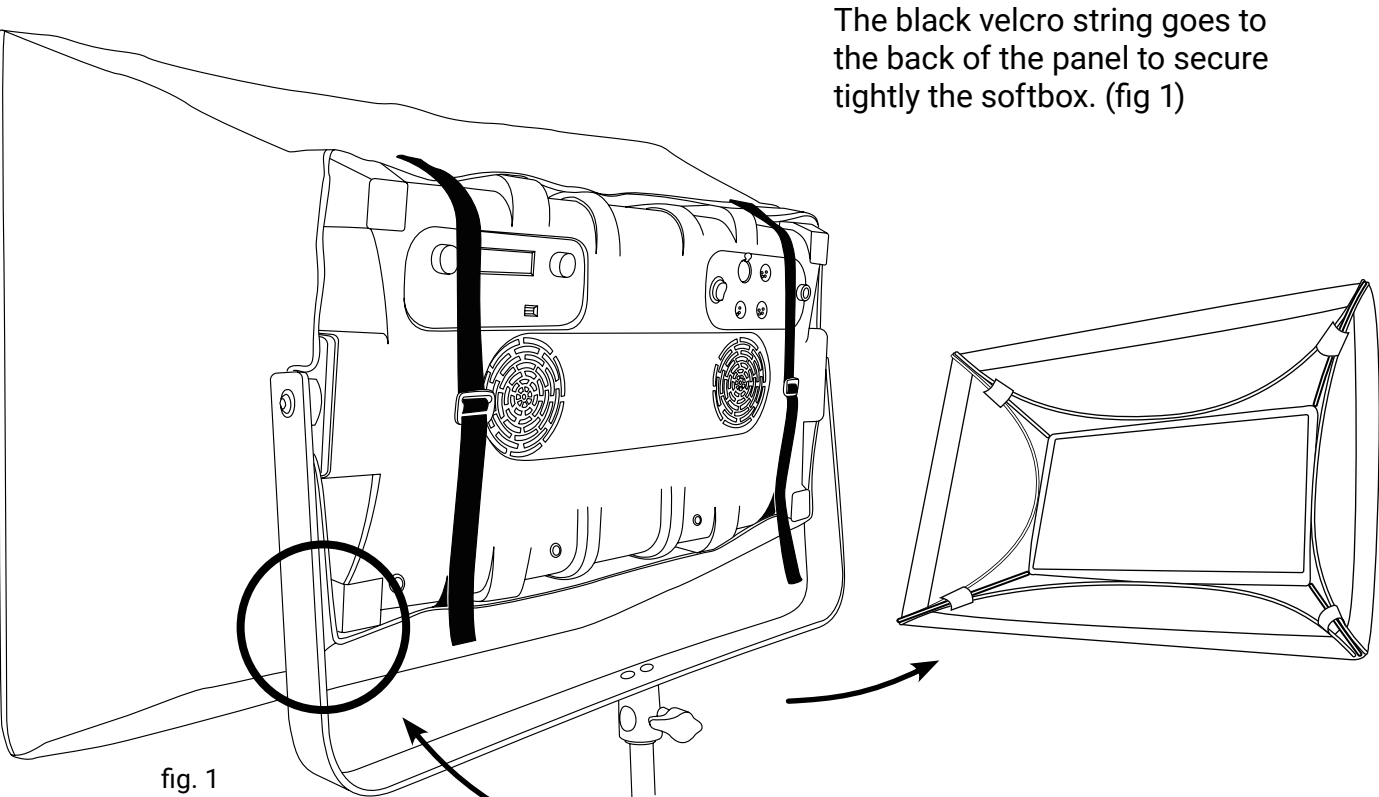

fig. 3

**SuperpanelPRO 60 and UltrapanelPRO 60 instructions**

Install the softbox on the SuperpanelPRO 60 and the UltrapanelPRO 60.



Tighten the velcro in the corner to close the gap between the softbox and the panel until it's secured.

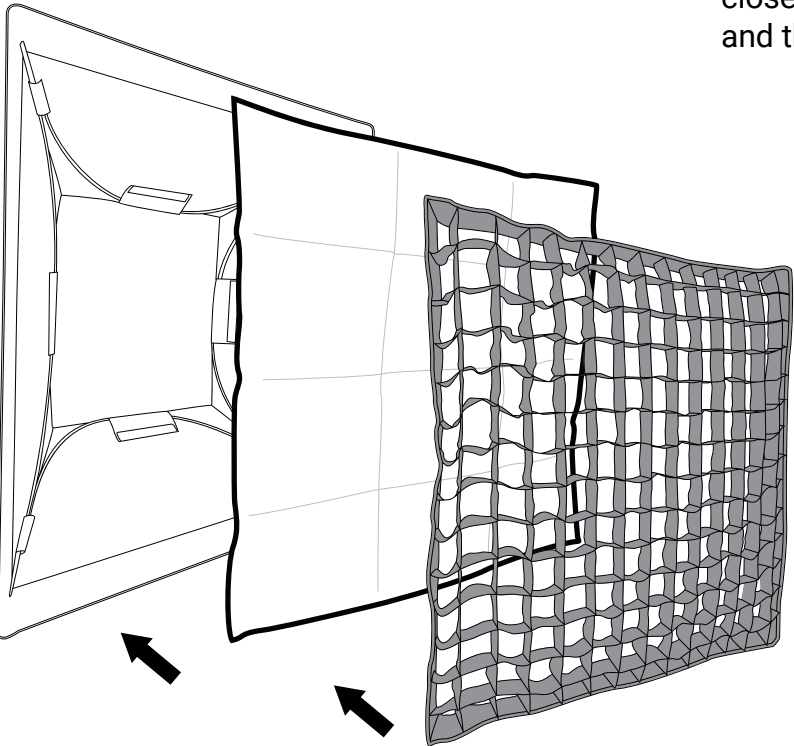

**DayledPRO 650, DayledPRO 1000 and DayledPRO 2000 instructions**

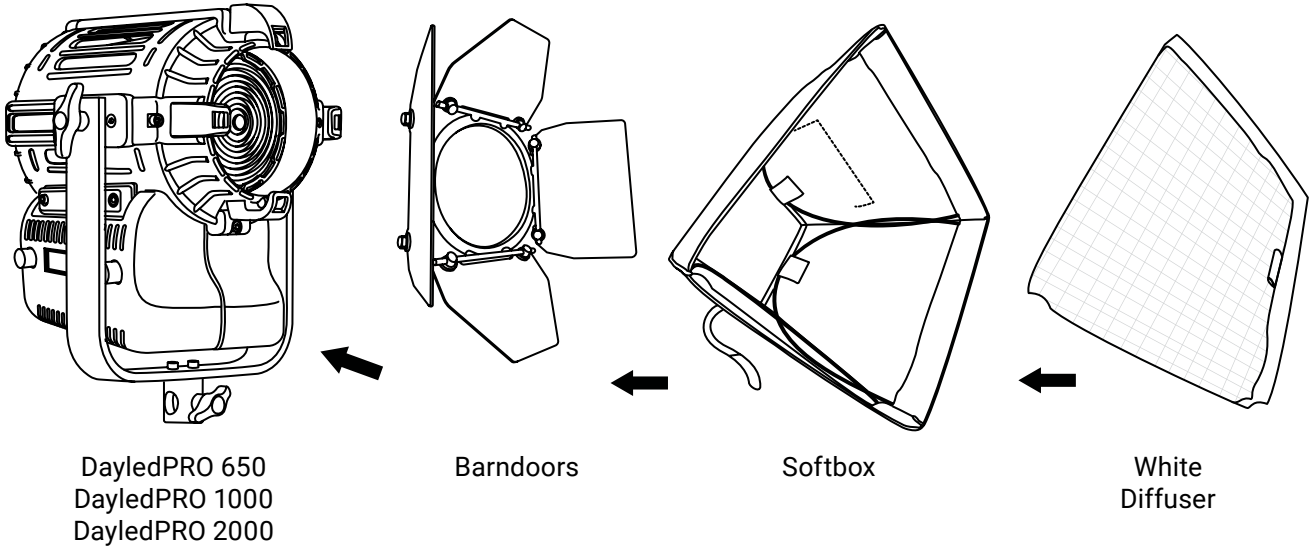

Insert the barndoors into the velcro pockets (fig. 1)  
Pass the string through the ring. (fig. 2)

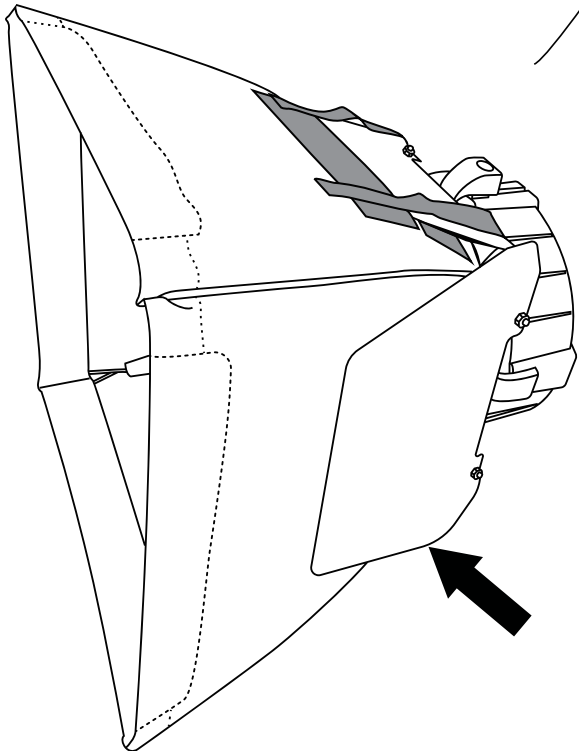
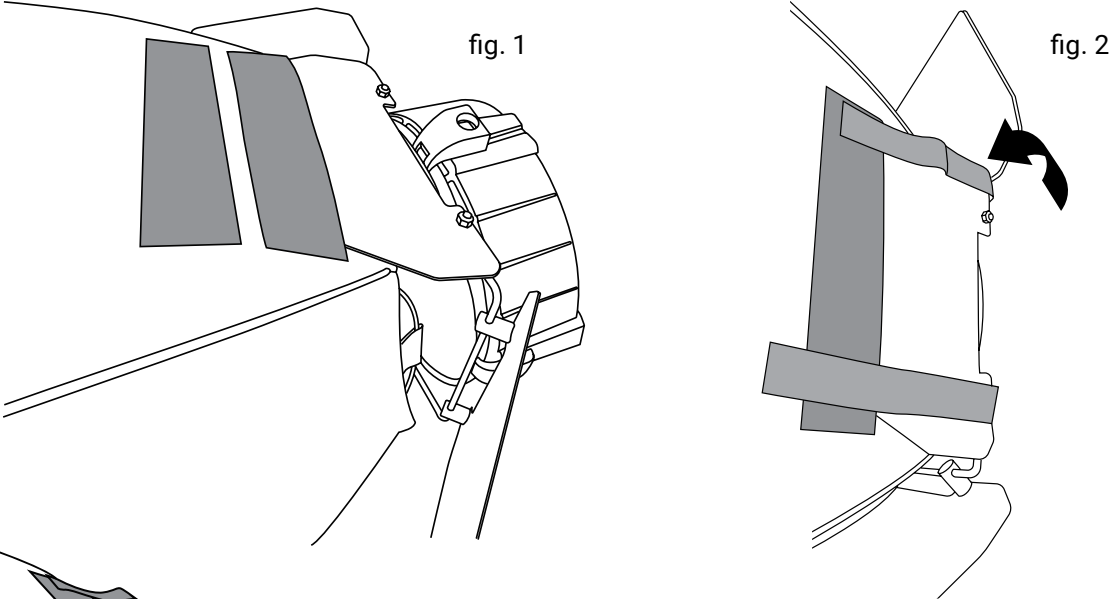

After tightening all the velcro straps position the barndoors next to the softbox. (fig. 3)

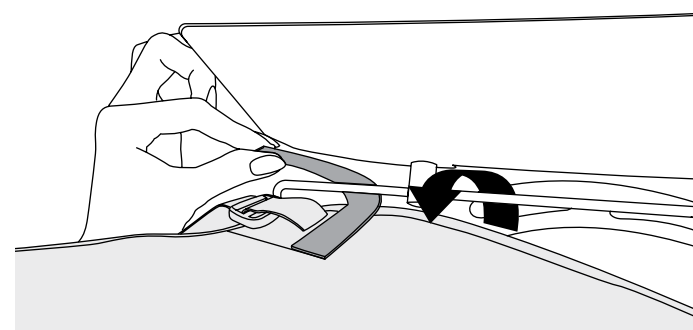
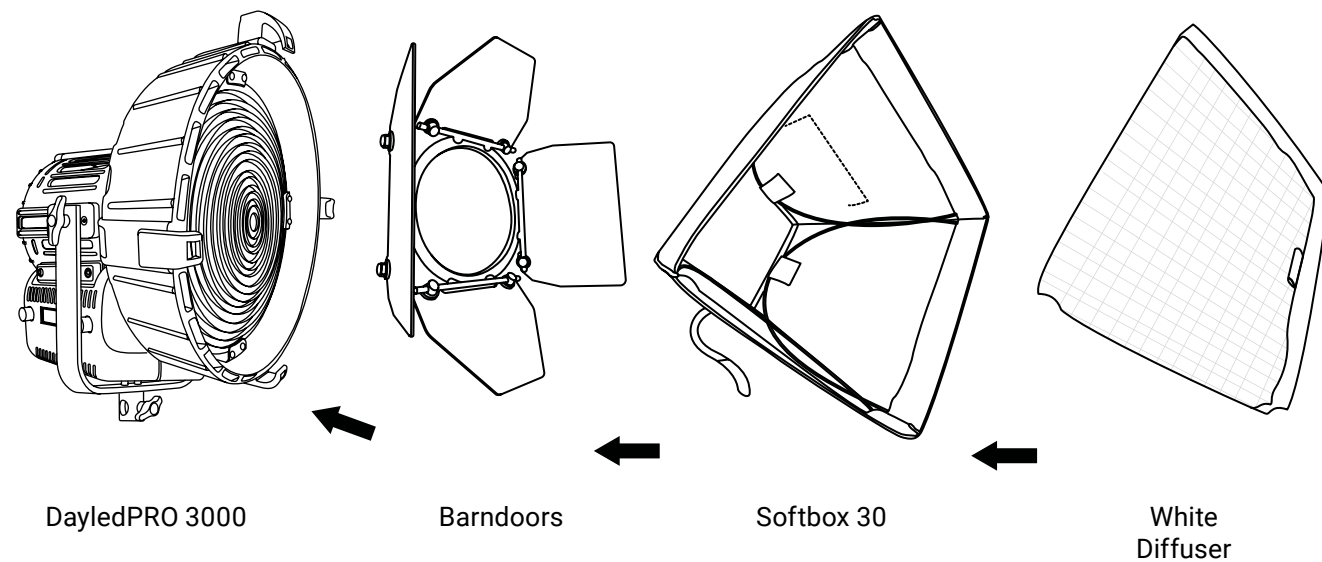

fig. 1

Pass the strings through the rod of the barndoor (fig.1) and attached them on the velcro. (fig.2)

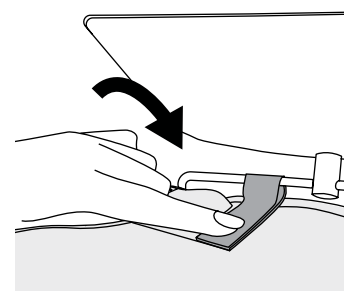

fig. 2

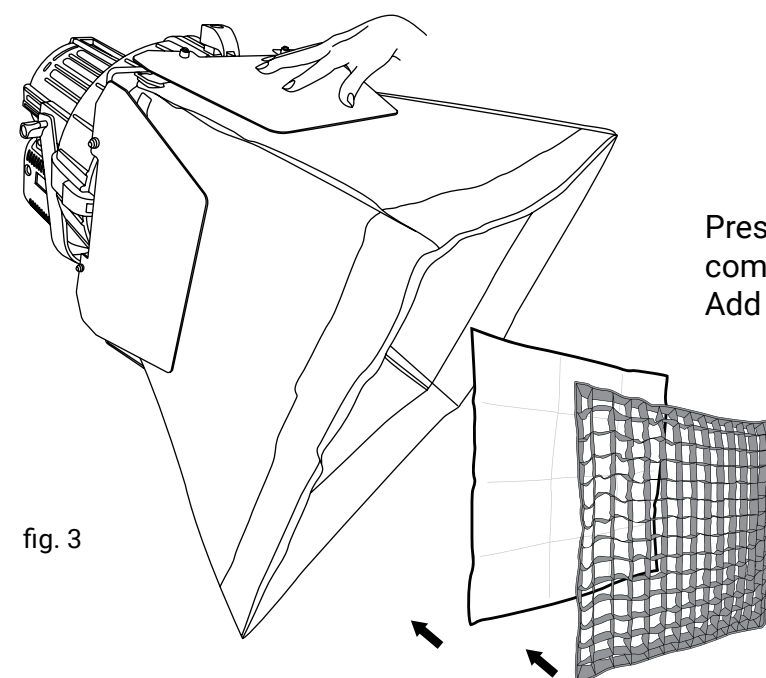
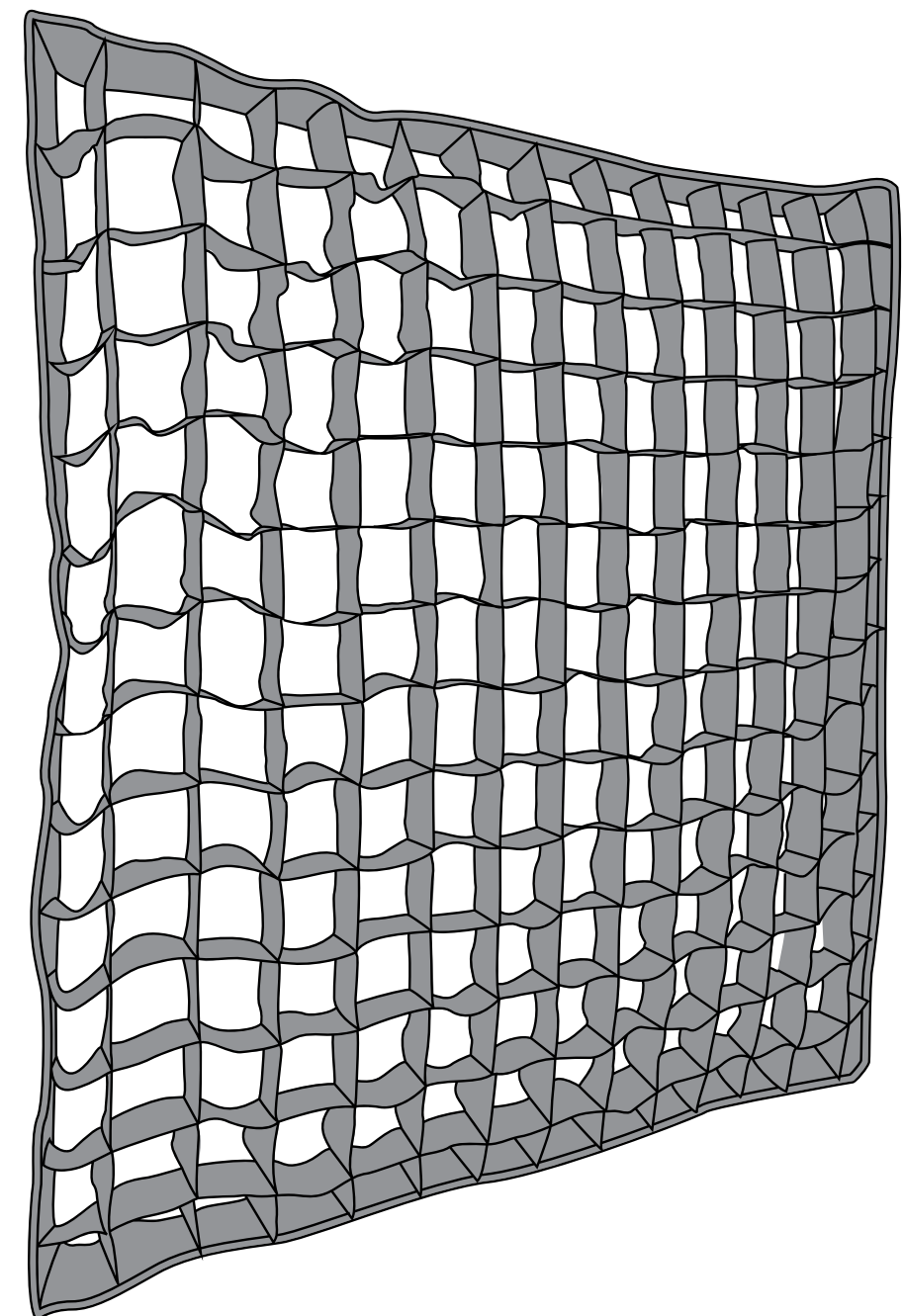

fig. 3

Press the barndoors to the softbox for a complete grip. (fig.3)  
Add the white diffuser at the velcro.



**User Manual**

**EGG CRATE**



## SuperpanelPRO 30 and UltrapanelPRO 30 instructions

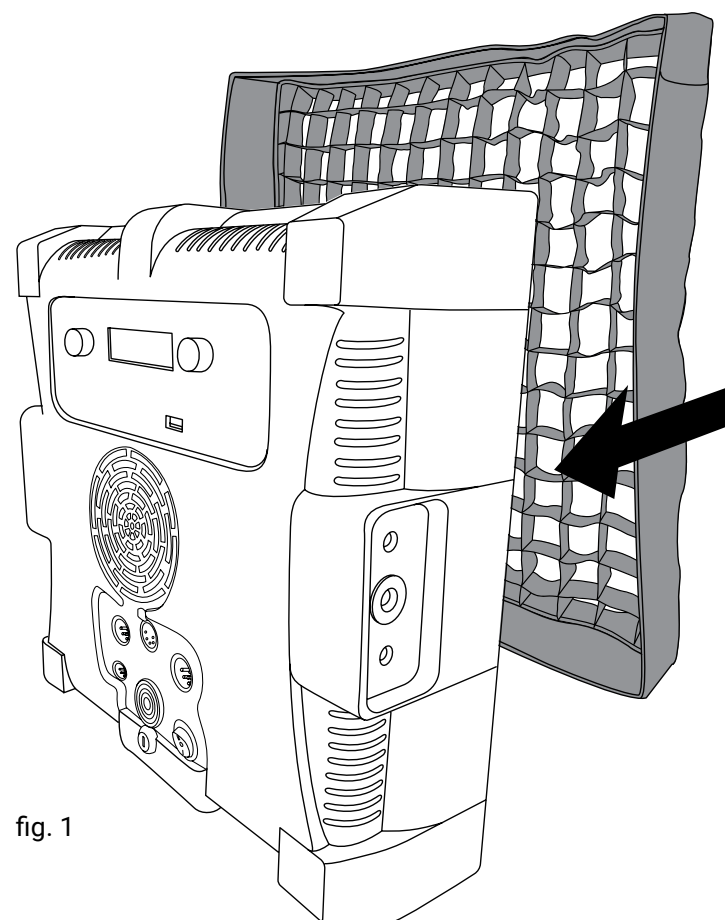

fig. 1

Attached the eggcrate to the panel.  
(fig. 1)

Tighten the velcro corners for a  
correct position on the panel. (fig. 2)

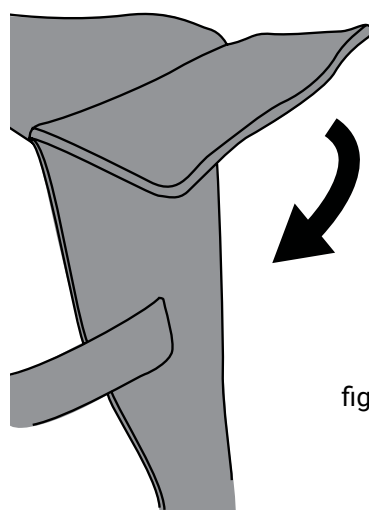

fig. 2

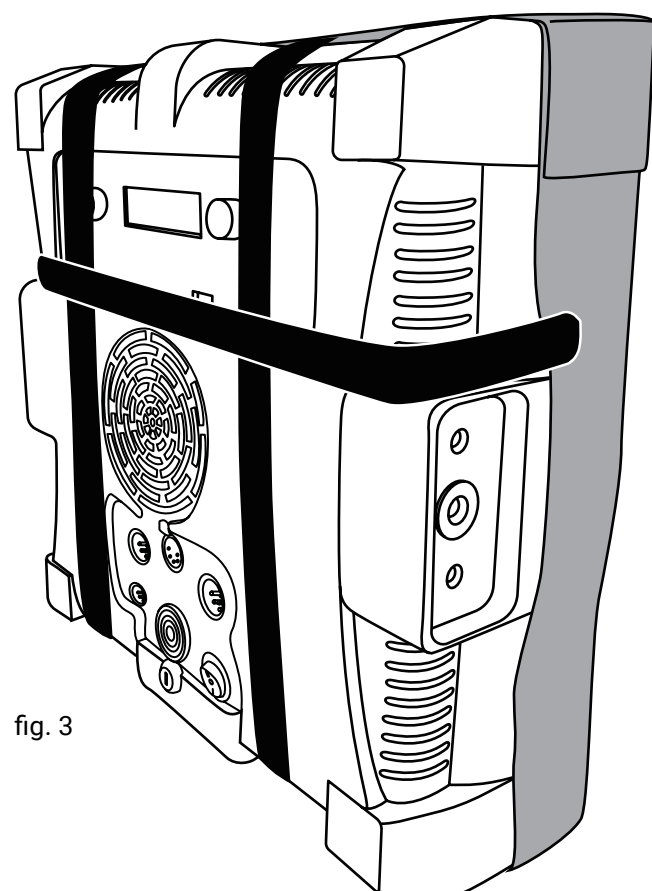

fig. 3

Pass the strings behind the panel and  
tighten them with the velcro.  
(fig. 3)

## SuperpanelPRO 60 and UltrapanelPRO 60 instructions

The same procedure applies for the SuperpanelPRO 60 and the UltrapanelPRO 60.

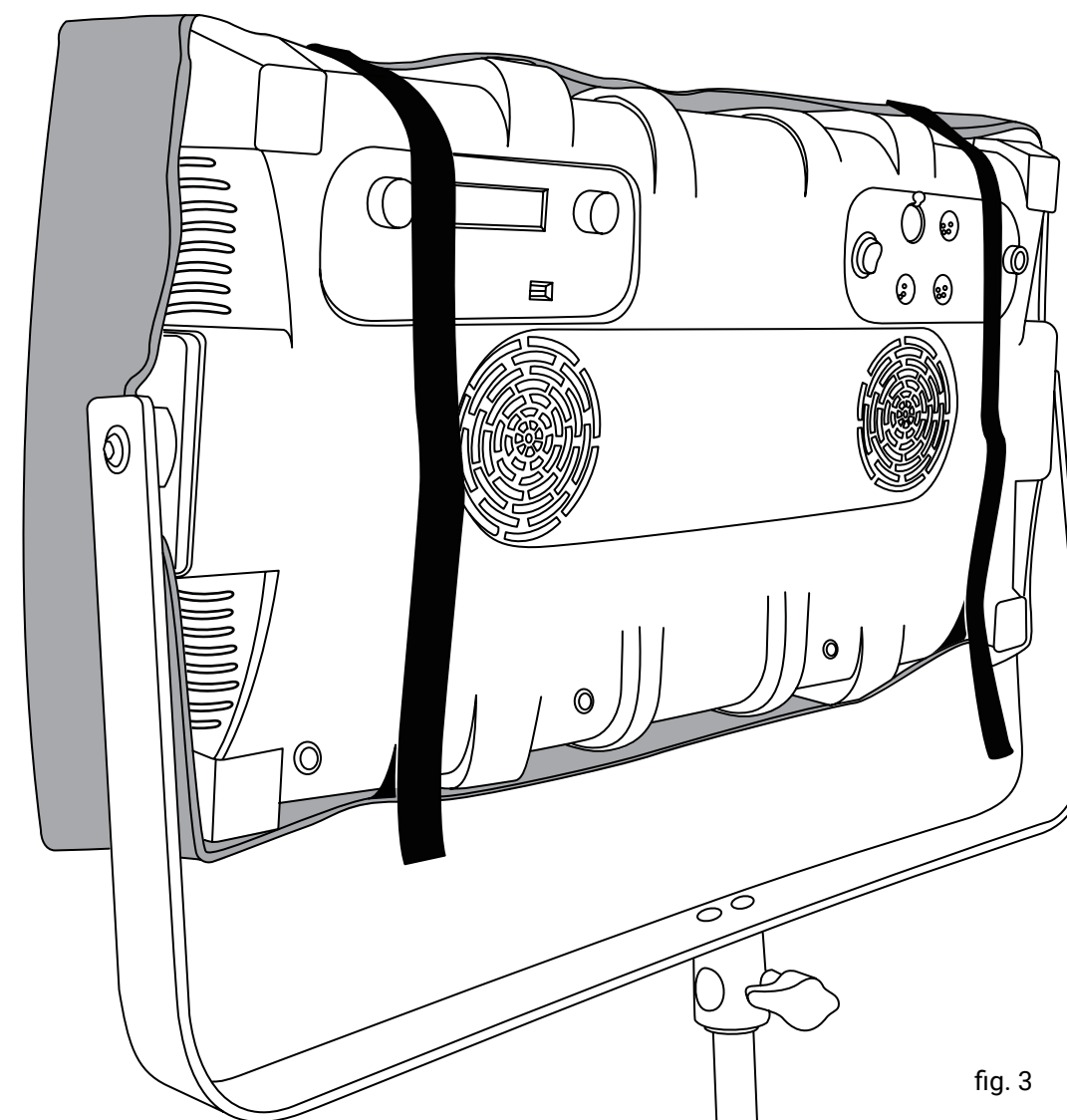

fig. 3